

Temperature sensor TS

DESCRIPTION

Temperature sensors TS are for measurement of a temperature in range from -55 °C to 125 °C. Sensors are compatible with TCM Sensor T, TCM and TCM BOX devices. Sensor has its address printed for quick and easy identification.

FEATURES

Digital communication

Temperature sensor is equipped with digital communication interface that guarantees correct measurement in every conditions.

Addressing

Every sensor has unique address for quick identification.

Cables

Sensor are available with 4 different cable lengths: 1m, 2m, 3m and 5m. Every ending is prepared to be quickly installed.

Sensor Networks

Multiple sensors can be connected to a single communication bus.

Waterproof

Enables for temperature measurement in every conditions.

PARAMETER	VALUE
Voltage supply	From 3 to 5 V DC
Measurement range	From -55 °C to 125 °C
Measurement resolution	0,1 °C
Measurement accuracy	±0,5 °C from -10 °C to 85 °C ±2 °C remaining range

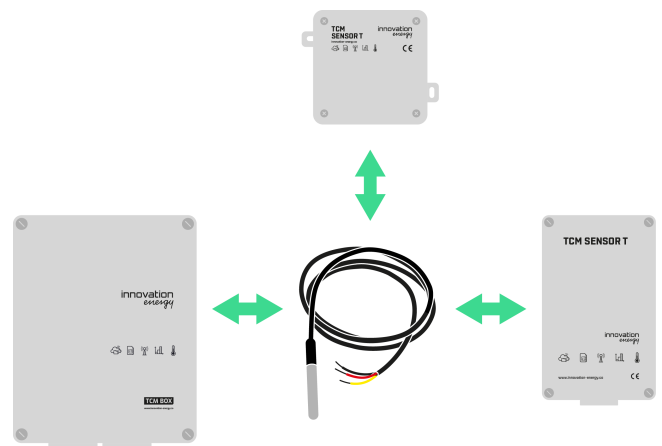

Sensor version	Cable length
TS 1m	1 m
TS 2m	2 m
TS 3m	3 m
TS 5m	5 m